

ZenVoice

Send my regards to Zennio for
making my life easier!



ZenVoice

What is it?

ZenVoice is the solution within Zennio Remote that allows you to create and manage compatible touch screen controls for use with voice assistants through an Amazon Alexa Skill or a Google Action in Google Home.



ZenVoice

What do I need to begin?

- Z50/Z70/Z100 with the following items:
 - ✓ Remote control and voice control license.
 - ✓ Alexa: application program 3.4. or latter versions along parameter for voice control enabled.
 - ✓ Google Home Assistant: application program 3.5. or latter versions along parameter for voice control enabled.



ZenVoice

1. Create a ZRC account

- Now you will have to update Zennio Remote app to the version 2.10.0 or latter:



- Once you have downloaded and installed that versión of Zennio Remote, create an user*.

This Will be your user for Zennio Remote Control (ZRC)

- * You can log in or register a new user by pressing the three bars on located on the top left corner.

ZRC user:

- E-mail : example@hotmail.com
- Password: Zennio123



Zennio Remote

ZenVoice – Setup for Alexa

2.1 Downloading Amazon Alexa (part 1)

- Download Amazon Alexa.
- If you already have a registered account for Amazon, simply log-in with it in Alexa app. In case you do not have an Amazon account, you will need to [create one](#).

• Amazon account:



- E-mail: cuenta@gmail.com
- Password: AmazonPW



These credentials refers to the ones from your Amazon account, used to access this platform.
It is not required for the e-mail registered for ZRC and your Amazon account to match.



ZenVoice – Setup for Alexa

2.2 Downloading ZenVoice skill for Alexa (part 2) HELP! I cannot find the ZenVoice Skill in Amazon Marketplace. What can I do? Check the following slider where this process is explained in Depth.

1. Search for the skill "ZenVoice" on Amazon Alexa Skill menu and download it.

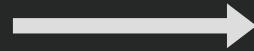

2. After downloading the skill, log-in with your ZRC account in order to link Amazon and ZRC accounts together.

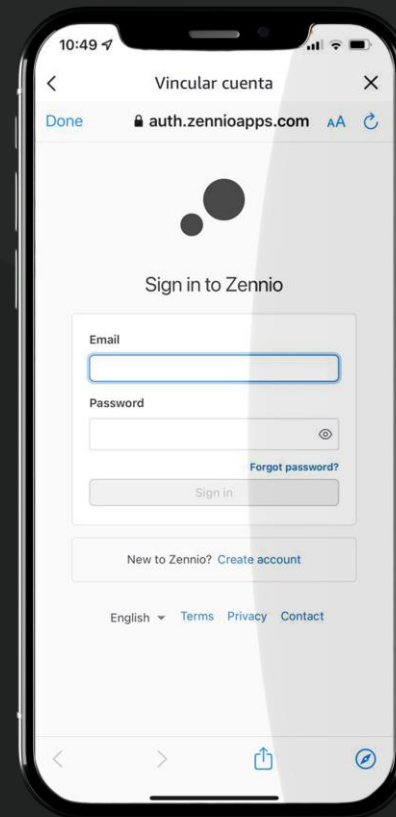

ZRC User:

- E-mail : ejemplo@hotmail.com
- Password: Zennio123

This step will link your ZRC account to your Amazon account. You will receive a notification via e-mail once both accounts are linked.

ZenVoice – Setup for Alexa

2.3 Downloading ZenVoice skill for Alexa (part 3)

HELP! I cannot find Alexa in Amazon's Marketplace.

- Amazon Alexa app is available for the following languages:

German (DE)
Spanish (SP)
French (FR)
English (EN)
Italian (IT)

- If you are unable to find Alexa app in your Marketplace, you will need to modify your country/region of your Amazon account:

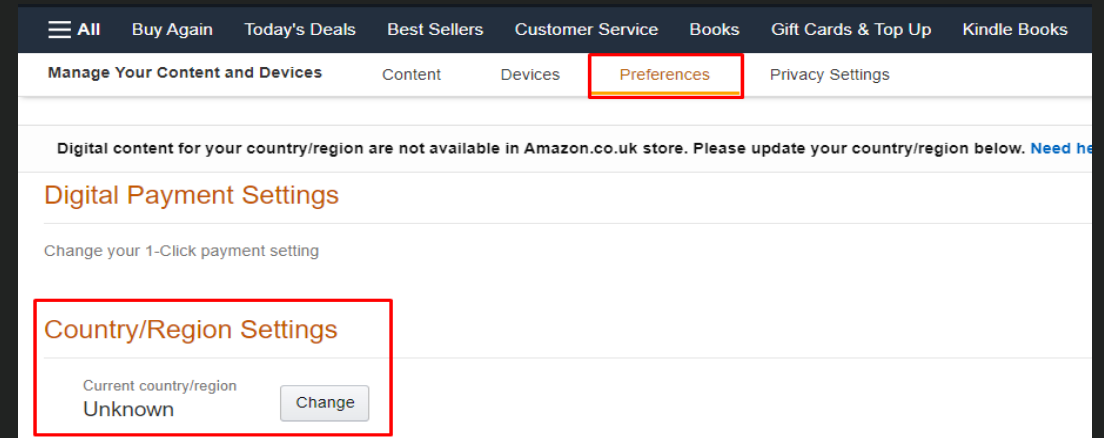
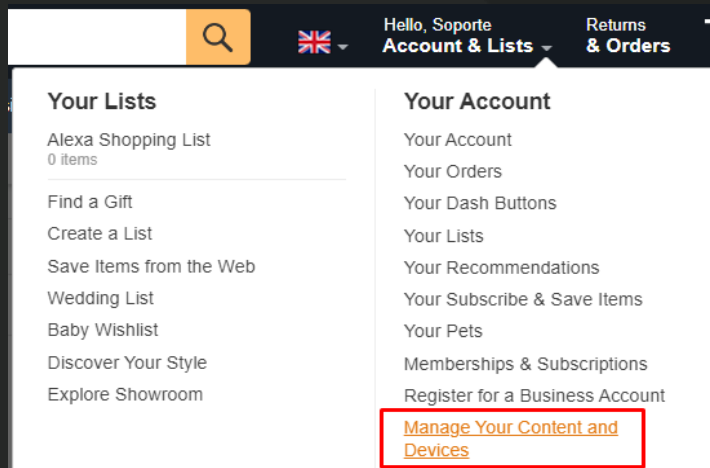

ZenVoice – Setup for Google Home Assistant

3.1 Downloading ZenVoice on Google Home (part 1)

The configuration of Google Home Assistant and ZenVoice requires the user to perform these steps:

1. Download the application "Google Home" and log-in with your Google account.
2. Press the "+" button on the upper left corner.
3. Next, select the option "Set up device".
4. Later, press "Works with Google" and search for "ZenVoice".

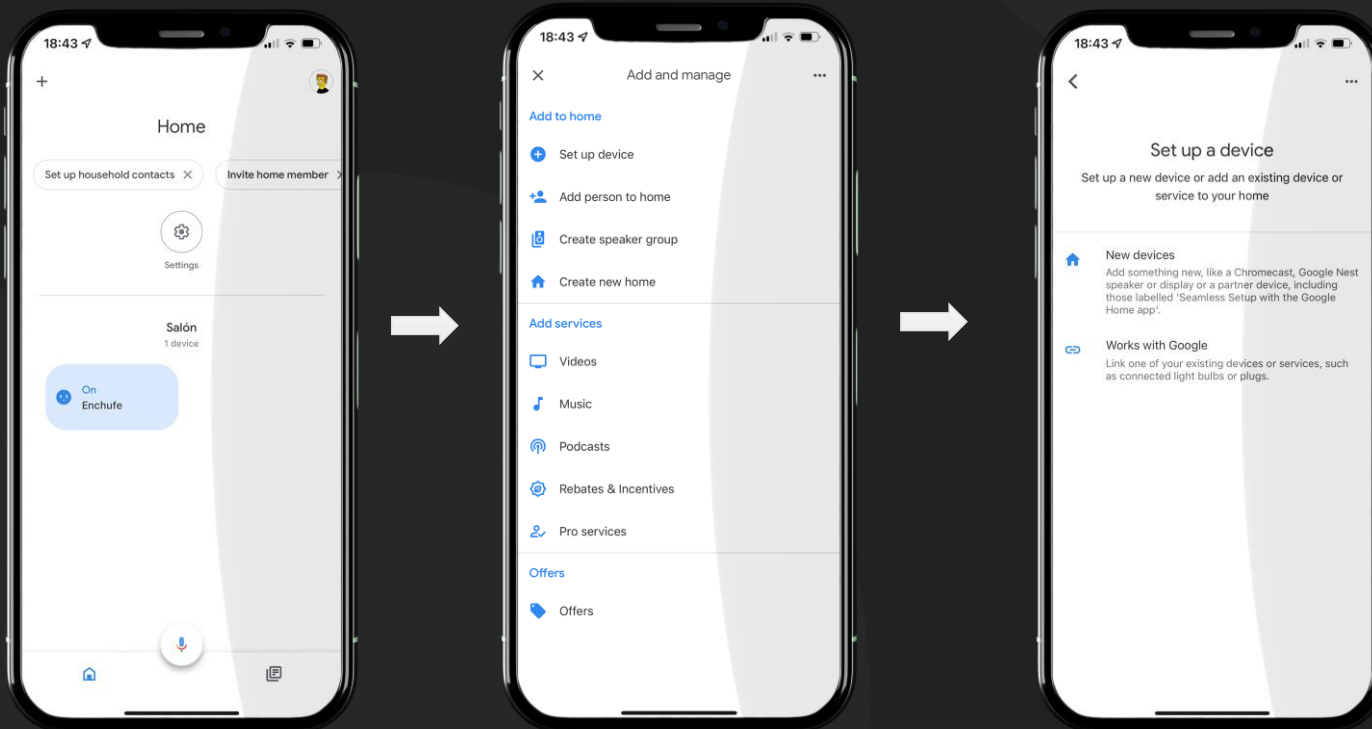

ZenVoice – Setup for Google Home Assistant

3.2 Downloading ZenVoice on Google Home (part 1)

To complete the setup, log-in with your ZRC account when you select “ZenVoice”. This last step will link both ZRC account and Google account.



ZenVoice

4. Access to ZenVoice

Your ZRC account is now linked to your Amazon/Google Home Assistant account!

- All the Z50/Z70/Z100 devices linked to your ZRC account will be displayed in your Zennio Remote portal.
- Access ZenVoice from Zennio Remote by tapping the three dots to display the Voice Control option.

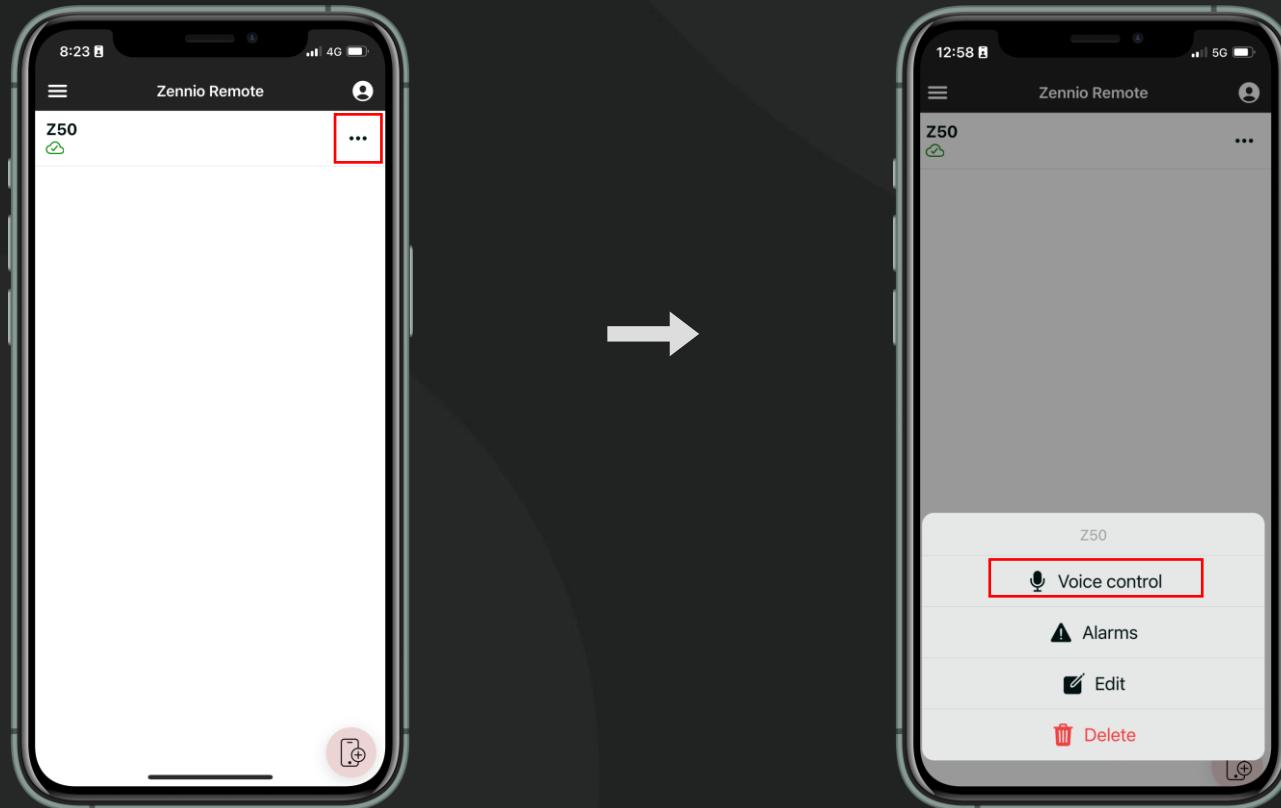

ZenVoice

5. Configure voice controls

It will be possible to configure those touch panels that fulfil these conditions:

1. ZenVoice or demo license is active.
2. Application program with voice control parameter enabled:
 1. 3.4 or latter for Alexa.
 2. 3.5 or latter for Google Home Assistant.

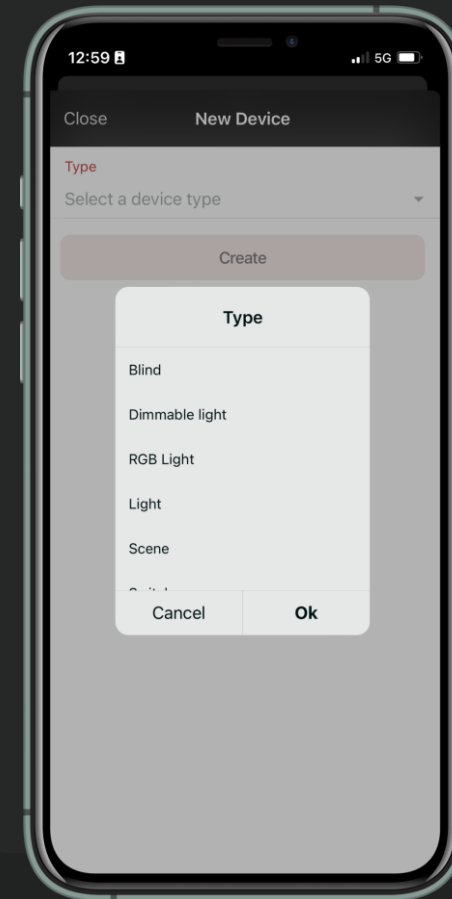
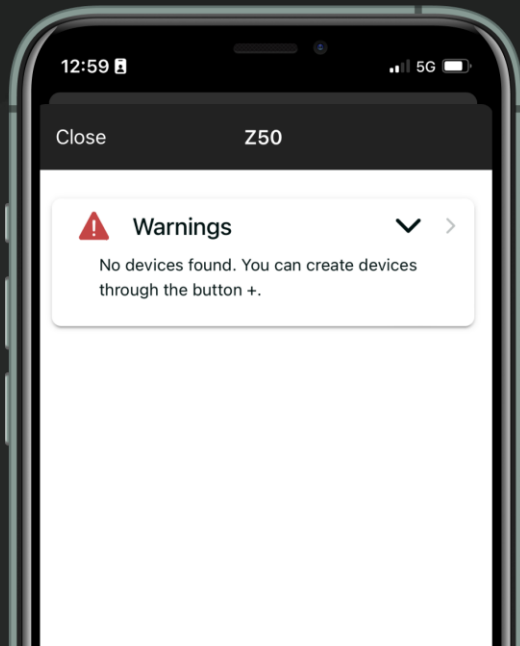

- When a type of control has been selected, ZenVoice will perform a quick search of the compatible controls, excluding those that does not match the criteria.
- For instance, switch and lighting On/Off controls would be equivalent, varying only the icons that represent each kind of control. Also, the voice controls for your voice assistant will require different key words:

Alexa, turn off all lights / OK Google, turn off all the lights → Lighting On/Off controls will be turned off, but not switch controls.

ZenVoice

6. Communicate with your voice assistant

- There are two options in order to transmit voice commands with voice assistant:
 1. Through your smartphone's APP:
 1. Amazon Alexa
 2. Google Home
 2. Using a Smart speaker compatible with Alexa or Google Home such as Amazon ECHO, Sonos, Google Nest...

Z50/Z70/Z100 IS NOT a smart speaker, it will only work as a gateway, so you MUST NOT voice the commands to Z50/Z70/Z100 .

- Alexa, turn on the lights.
- OK!



ZenVoice

7.1 Compatibles controls and voice commands

- **Switch & On/Off control**
 - Alexa! Turn on lamp light.
 - Alexa! Turn on ceiling fan.
 - Alexa! Turn off AC.
- **Temperature sensor control**
 - Alexa! What is the temperature of the Office?
 - Alexa! What is the temperature of Bedroom?
- **Dimmer control**
 - Alexa! Ceiling light brightness 50%.
 - Alexa! Turn on ceiling light.
- **Scene control**
 - Alexa! Turn on "scene control name".
 - Alexa! Turn on exit.
 - Alexa! Turn on cinema.
- **Thermostat control**
 - Alexa! Set thermostat to 23 degrees.
 - Alexa! Lower living room temperatura 2 degrees.
- **Shutter control**
 - Alexa! Raise/lower the blind.
 - Alexa! Set blind to 60%.
- **RGB light control**
 - Alexa! Turn on RGB light.
 - Alexa! Set RGB grey.

IMPORTANT!

For dimmer controls to work, it is mandatory to link precise dimming (1 byte) since voice assistants do not allow the use of relative dimming (4-bit).





ZenVoice

7.2 Compatibles controls and voice commands

- **Switch & On/Off control**
 - OK Google, turn on lamp light.
 - OK Google, turn on ceiling fan.
 - OK Google, turn off AC.
- **Temperature sensor control**
 - OK Google, What is the temperature of the Office?
 - OK Google, What is the temperature of Bedroom?
- **Dimmer control**
 - OK Google, ceiling light brightness 50%.
 - OK Google, turn on ceiling light.
- **Scene control**
 - OK Google, turn on "scene control name".
 - OK Google, turn on Exit.
- **Thermostat control**
 - OK Google, set thermostat to 23 degrees.
 - OK Google, lower living room temperature 2 degrees.
- **Shutter control**
 - OK Google, raise/lower the blind.
 - OK Google, set blind to 60%.
- **RGB light control**
 - OK Google, turn on RGB light.
 - OK Google, set RGB grey.

IMPORTANT!

For dimmer controls to work, it is mandatory to link precise dimming (1 byte) since voice assistants do not allow the use of relative dimming (4-bit).

ZenVoice

8. Advisory

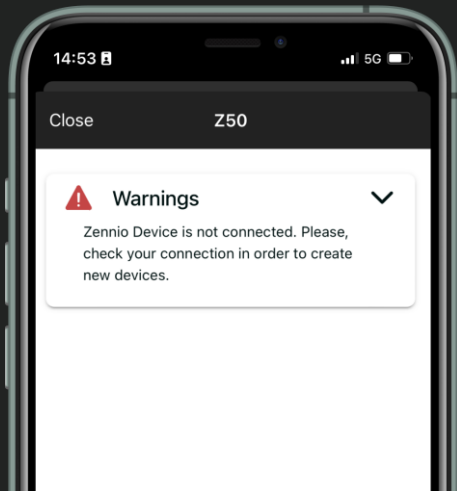

Attention! Your Zennio device is not connected to the network. Check your connection and find more details about the network status in Appendix III of the manual.



Oops! The version of your Zennio device is not compatible. Update the screen to enjoy this and more features.

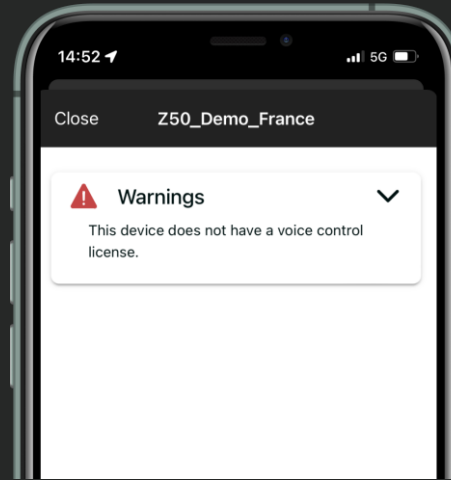

To enjoy voice control, you need the ZenVoice License. Get it now!

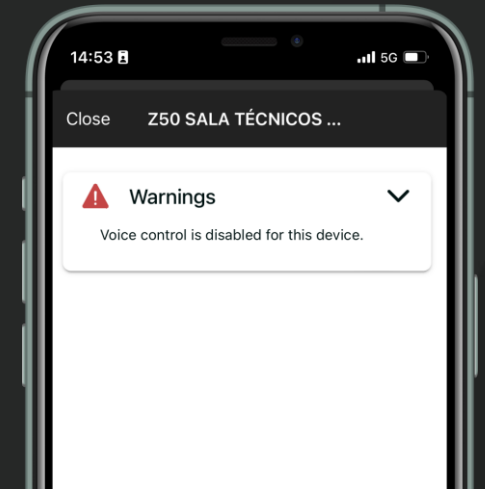

Wow! It seems like voice control is turned off. Activate it from the screen configuration to start using it



To continue enjoying an uninterrupted experience, remove the old controls and create new ones.

•Zennio