

# Smart Home WiFi Outdoor Camera

## Manual

WiFi Kamera

WiFi Cámara

Camera WiFi

Caméra WiFi

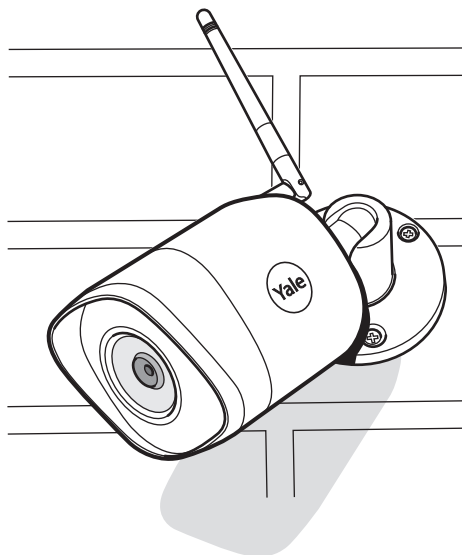

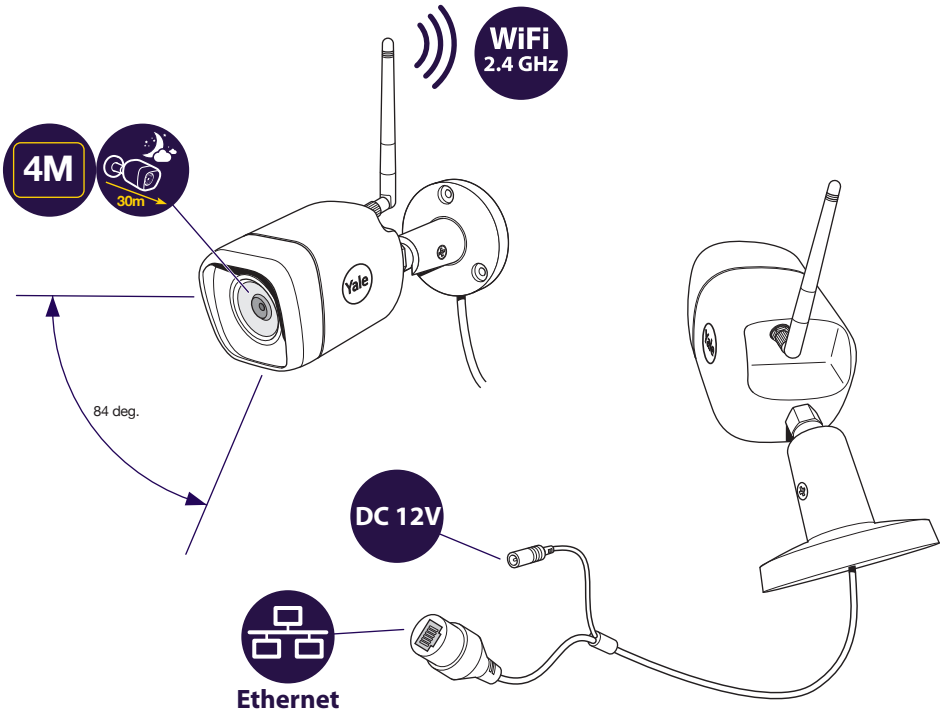

Not included  
MAX 32GB  
microSD

Nicht enthalten  
Non inclusa  
Non inclus  
No incluido

Max 32GB

**Press 10 sec**  
Reset  
Reiniciar  
Zurücksetzen  
Réinitialiser

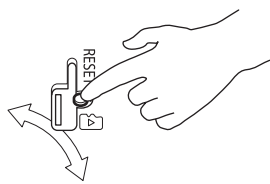

**Press 1 sec**  
WPS  
(Wi-Fi Protected Setup)

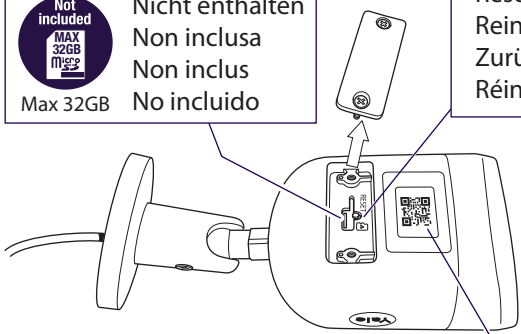

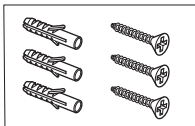
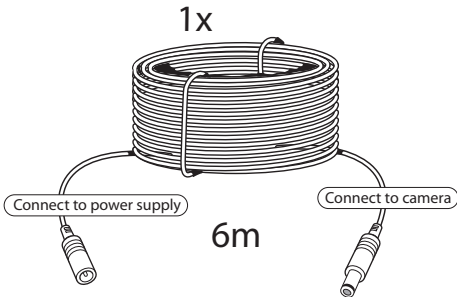
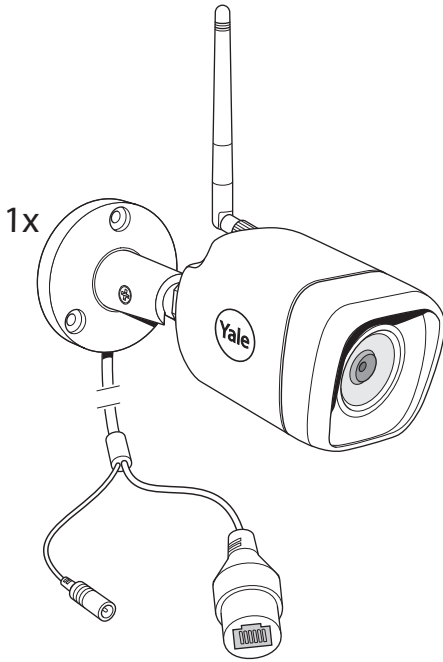

1x

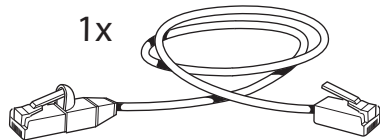
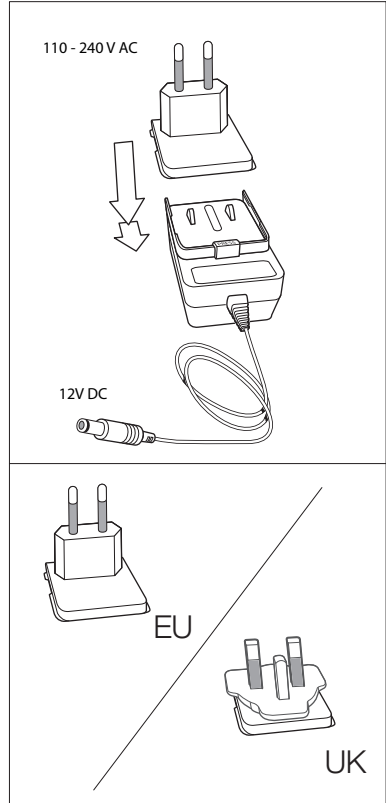

1

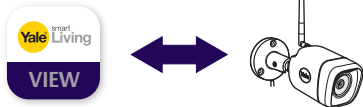

Download App

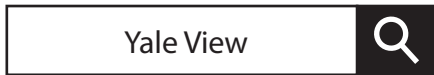

2

Insert Micro SD card

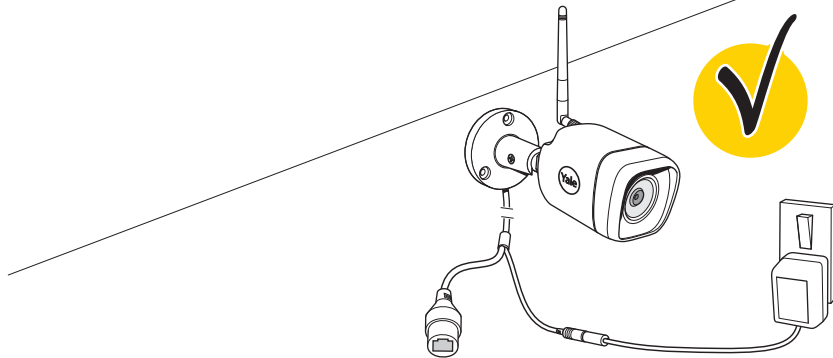
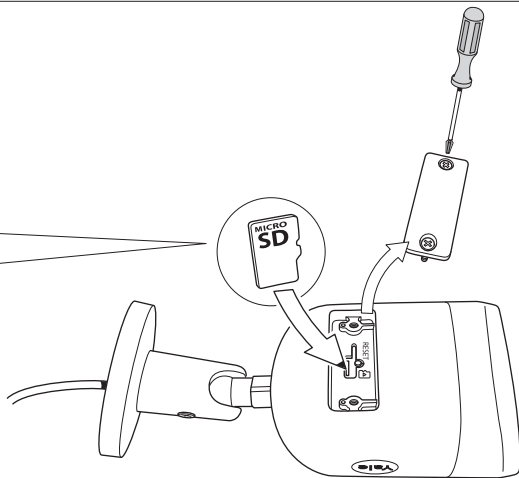
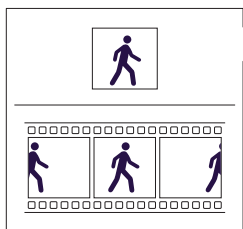

### 3 Create Account

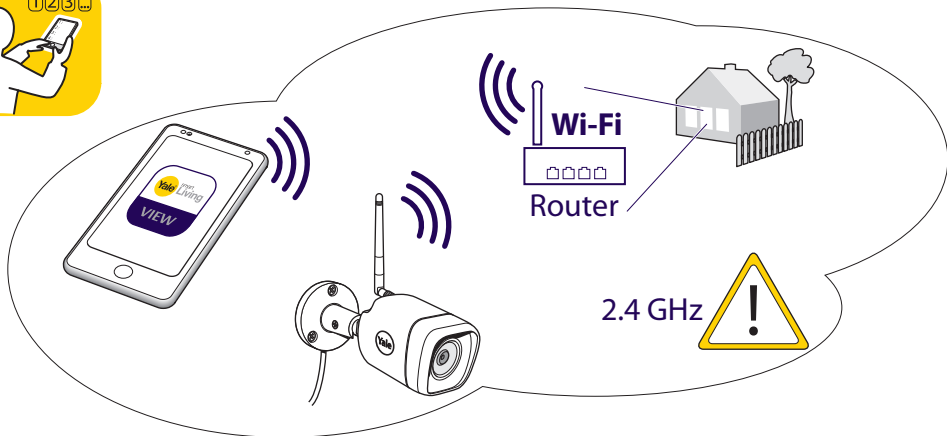

**a**



Email Register

Send verification code to mail

**b**



Email verification

 116s

**c**



Create a Password

## 4 App - Setup camera

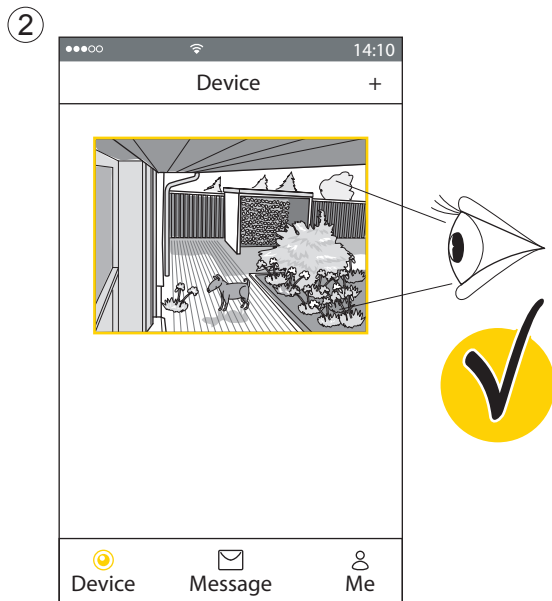
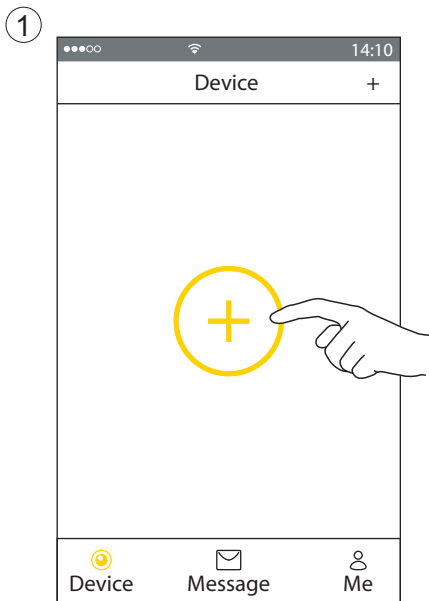
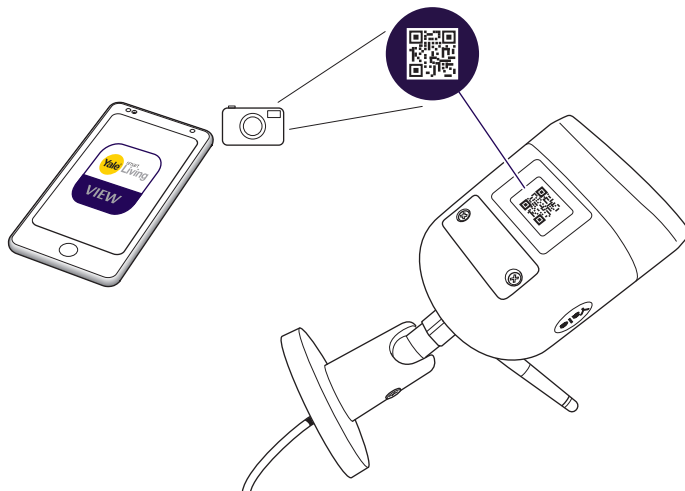

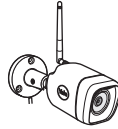
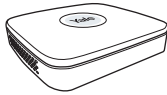

[www.yalelock.com/smart-living](http://www.yalelock.com/smart-living)

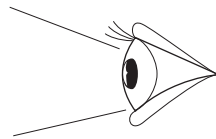
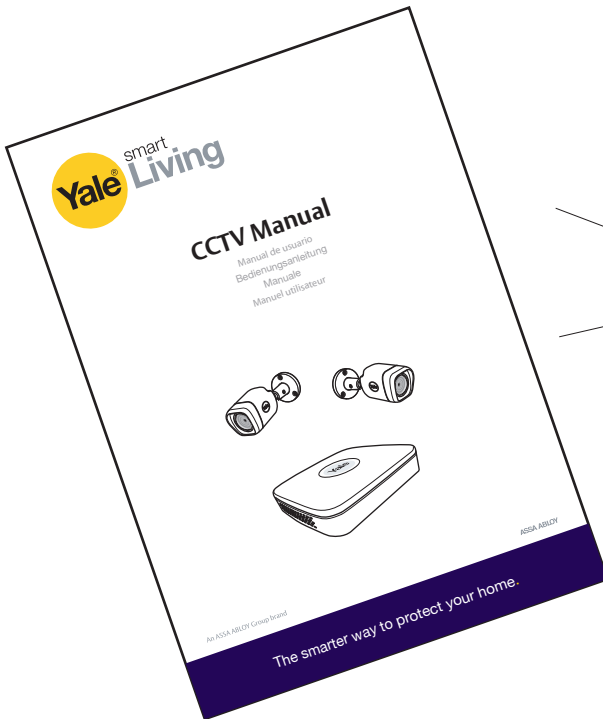

1

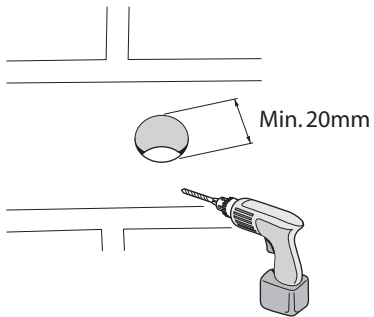

2

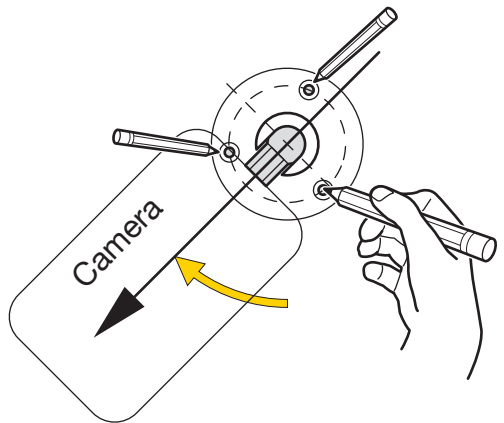

3

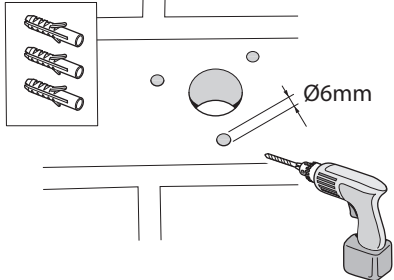

4

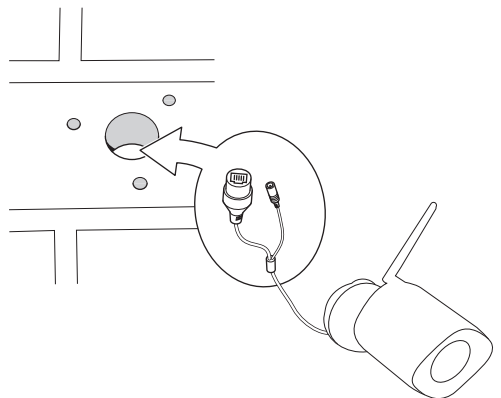

5

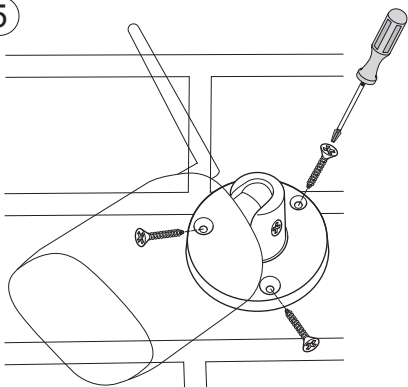

6

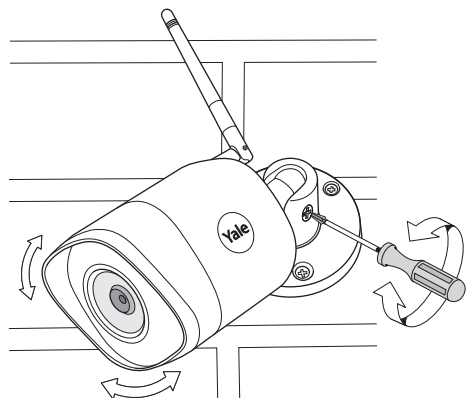



i

**GB:**

Hereby, ASSA ABLOY Ltd., School Street, Willenhall, West Midlands, England Wv13 3PW declares that the radio equipment type SV-DB4MX-B is in compliance with Directive 2014/53/EU. The full text of the EU declaration of conformity is available at the following internet address: [www.yalelock.com/smart-living/doc](http://www.yalelock.com/smart-living/doc)

**FR:**

Le soussigné, ASSA ABLOY Ltd., School Street, Willenhall, West Midlands, England Wv13 3PW, déclare que l'équipement radioélectrique du type SV-DB4MX-B est conforme à la directive 2014/53/UE. Le texte complet de la déclaration UE de conformité est disponible à l'adresse internet suivante:

[www.yalelock.com/smart-living/doc](http://www.yalelock.com/smart-living/doc)

**\*\*\* Message à destination des professionnels \*\*\***

*Si vous souhaitez installer SV-DB4MX-B dans votre société, vous devez obligatoirement demander une autorisation à la Commission Nationale de l'Informatique et des Libertés.*

**ES:**

Por la presente, ASSA ABLOY Ltd., School Street, Willenhall, West Midlands, England Wv13 3PW declara que el tipo de equipo radioeléctrico SV-DB4MX-B es conforme con la Directiva 2014/53/UE. El texto completo de la declaración UE de conformidad está disponible en la dirección Internet siguiente:

[www.yalelock.com/smart-living/doc](http://www.yalelock.com/smart-living/doc)

**DE:**

Hiermit erklärt ASSA ABLOY Ltd., School Street, Willenhall, West Midlands, England Wv13 3PW, dass der Funkanagentyp SV-DB4MX-B der Richtlinie 2014/53/EU entspricht. Der vollständige Text der EU-Konformitätserklärung ist unter der folgenden Internetadresse verfügbar: [www.yalelock.com/smart-living/doc](http://www.yalelock.com/smart-living/doc)

**IT:**

Il fabbricante, ASSA ABLOY Ltd., School Street, Willenhall, West Midlands, England Wv13 3PW, dichiara che il tipo di apparecchiatura radio SV-DB4MX-B è conforme alla direttiva 2014/53/UE. Il testo completo della dichiarazione di conformità UE è disponibile al seguente indirizzo Internet: 22.5.2014 L 153/104 Gazzetta ufficiale dell'Unione europea IT: [www.yalelock.com/smart-living/doc](http://www.yalelock.com/smart-living/doc)

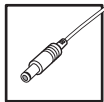

Frequency / Band	EIRP [dBm]
WiFi 2400MHz~2483.5MHz	10 - 15dBm

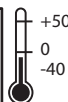
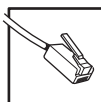
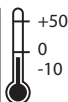

Less than 95% RH



Outdoor





## **i** Support



## **i** Manual

[www.yalelock.com/smart-living](http://www.yalelock.com/smart-living)

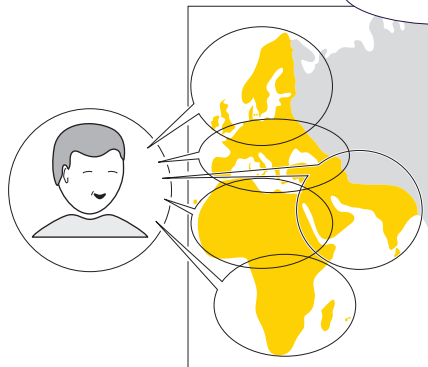

**THE YALE BRAND**, with its unparalleled global reach and range of products, reassures more people in more countries than any other consumer locking solution.

**THE ASSA ABLOY GROUP** is the world's leading manufacturer and supplier of locking solutions, dedicated to satisfying end-user needs for security, safety and convenience.

An ASSAABLOY Group brand

**ASSA ABLOY**